

# Greater Hartford Campus Master Plan

## Final Master Plan

October 14, 2004



University of  
Connecticut

# Planning Purpose

- ❑ Space Needs Analysis
- ❑ Facilities Assessment
- ❑ 21<sup>st</sup>. Century UConn Master Plan
- ❑ Vision for Future Campus Development



# Planning Process

- ❑ Kick-off Meeting
- ❑ Campus walk
- ❑ Public Session
- ❑ Space Needs Survey
- ❑ Facilities Assessment
- ❑ Preliminary Findings
- ❑ Final Master Plan





# Enrollment Summary

---

- ❑ Enrollment growth is projected at 7% for Fall 2004, 5% for Fall 2005, 9% for Fall 2006 and stable through the 2013 target year plus 60 students each for the Teacher Certification Program and Public Affairs programs
- ❑ Enrollments are projected to grow from a Fall 2003 headcount of 1,187 to a projected headcount of 2,082 for the Fall 2013 target year and staffing growth of 23%
- ❑ Enrollment growth is justified by several bachelor's degree programs and five master's degree programs in the planning stages
- ❑ Projections assume the School of Business Administration moving to downtown Hartford

# Space Needs Analysis Summary

---

- ❑ The campus needs 30,140 ASF additional space by 2013
- ❑ Current space provides 82 ASF per FTE with 87 ASF per FTE at target year
- ❑ Academic Space increase of 21% needed (classrooms, labs, research space, office, other departmental space)
- ❑ Academic Support Space increase of 41% needed (library, assembly & exhibit, Zachs Community Center, physical plant)
- ❑ Auxiliary Space increase of 42% needed (recreation, student union)

# Facilities Assessment

- ❑ Former School of Law - can be redeveloped
- ❑ Undergraduate Building – can be redeveloped
- ❑ School of Social Work – prohibitively expensive to renovate





# Existing Campus Assessment

- ❑ Not a powerful image to the community
- ❑ Parking area across Trout Brook Road not adequately maintained
- ❑ Trout Brook Drive pedestrian crosswalk unsafe
- ❑ Campus identification signage not prominent
- ❑ Campus edges lack sense of arrival
- ❑ Campus organization does not create vibrant community spaces
- ❑ Excessive areas of mowed lawns



# Master Plan Objectives

---

- ❑ Establish a more traditional campus setting
  - Expand student life amenities
  - Expand and upgrade dining services
  - Enhance facility quality
  - Improve access to technology
- ❑ Promote a campus setting that encourages inter-departmental collaboration.
  - Maintain one campus library and student union
  - Cluster buildings and funnel pedestrian circulation
- ❑ Promote faculty and student interaction
  - Integrate faculty offices and classrooms
  - Provide social areas/niches for informal gathering
- ❑ Strengthen the campus' public image
  - Consider positioning future buildings to address the campus edge
  - Enhance the campus' edge landscape and signage treatment



# Master Plan Objectives

---

- ❑ Enhance campus security.
  - Enhance the pedestrian crosswalk over Trout Brook Road
  - Incorporate more emergency phones and ensure adequate night lighting
  - Open up visibility of the commuter/visitor parking lot from Trout Brook Road
- ❑ Reduce operational maintenance
  - Reduce higher-maintenance aspects of the landscape
  - Consider native landscaping
- ❑ Maintain flexibility to accommodate future growth/change.
  - Develop a long-term framework for growth and phasing strategy.

# Drivers for Change

---

- ❑ The Hartford Academic Program will expand beyond available space
- ❑ Renovation of the School of Social Work is not cost effective
- ❑ Library and community spaces are Inadequate
- ❑ A stronger campus image is needed

## **CAMPUS DEVELOPMENT PLAN (UConn 21)**

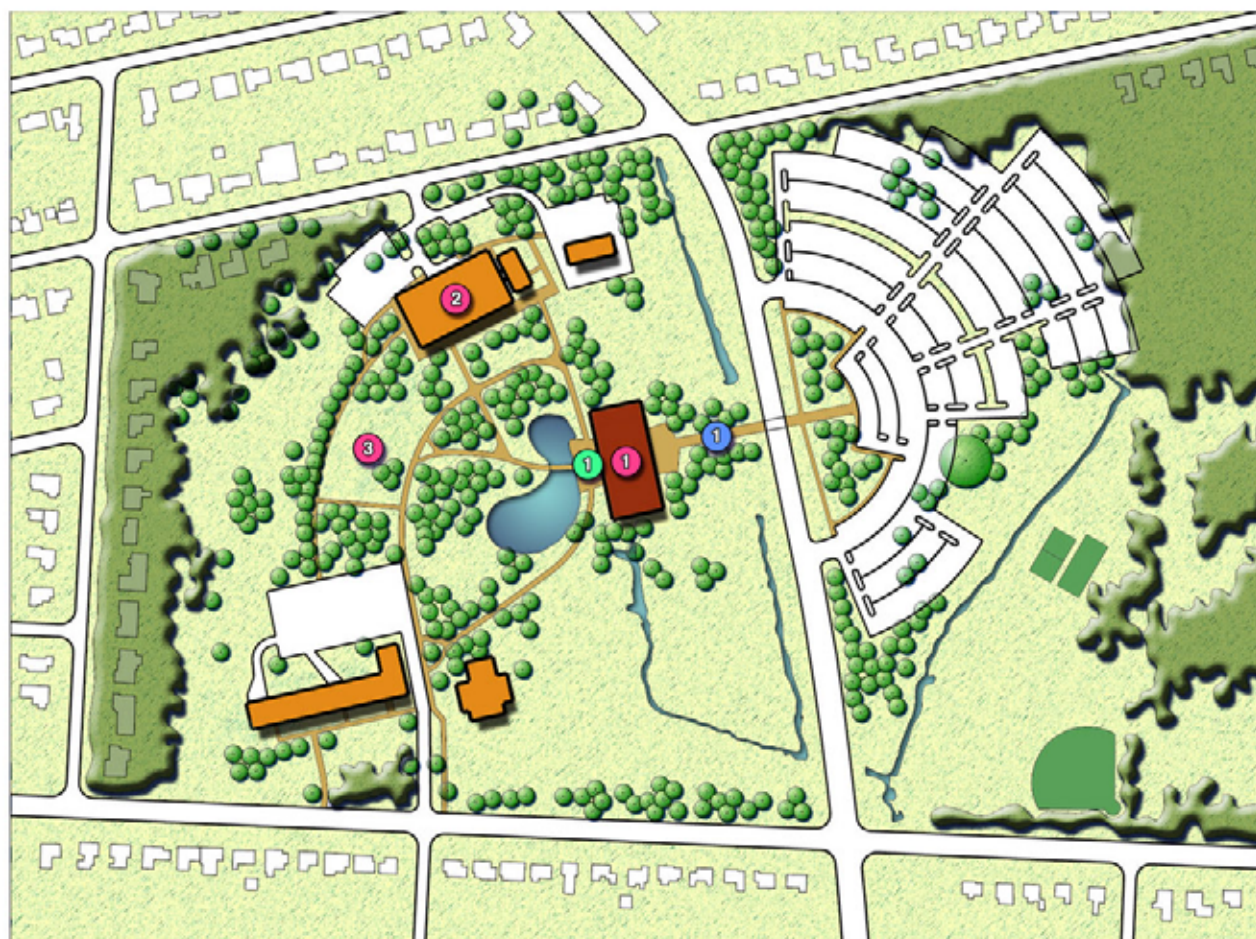

### **Buildings and Facilities**

- 1 - New Undergraduate / Multi-use Building
- 2 - Renovate Undergraduate Building
- 3 - Demolish School of Social Work Building

### **Open Space**

- 1 - New Plaza Space

### **Circulation**

- 1 - Walkway Enhancement





## **CAMPUS DEVELOPMENT PLAN (BEYOND UCONN 21)**



### **Buildings and Facilities**

- 1 - Undergraduate Building Addition
- 2 - Addition to Old School of Law
- 3 - Academic Building
- 4 - New Facilities / Maintenance Building / Yard
- 5 - Daycare Facility

### **Open Space**

- 1 - Landscape Enhancement
- 2 - Focal Point
- 3 - Low Maintenance Landscaping
- 4 - Stormwater Detention
- 5 - Campus Sign

### **Circulation**

- 1 - Additional Faculty / Staff Parking
- 2 - Crosswalk Enhancement
- 3 - New Campus Walkway System
- 4 - Relocated Entrance

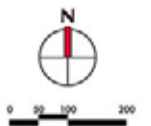

[www.masterplan.uconn.edu](http://www.masterplan.uconn.edu)



University of  
Connecticut